

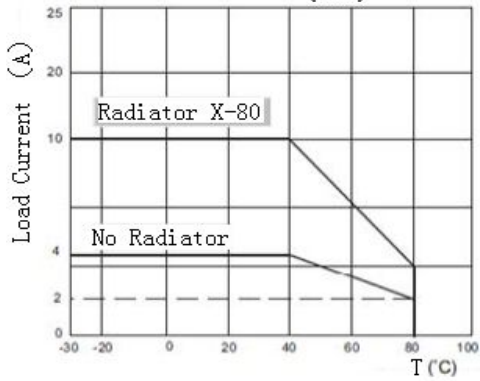

■ Reference data

Load current-environment temperature (10A)



Load current-environment temperature (15A)

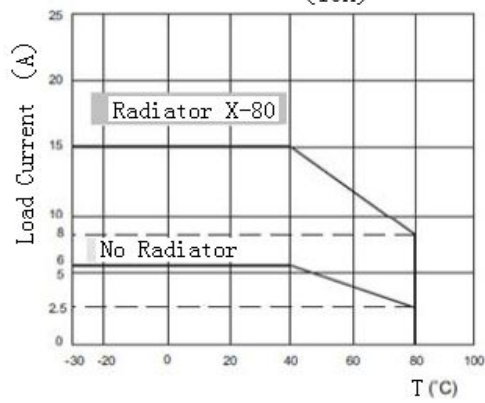

Load current-environment temperature (20A)

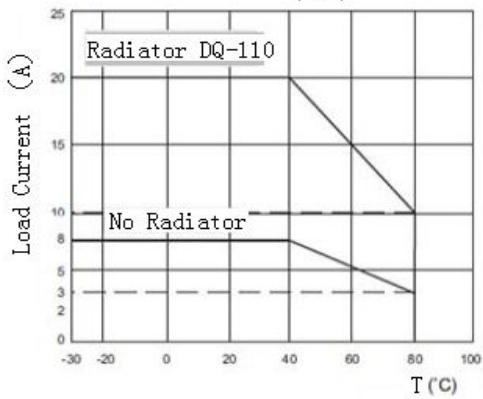

Load current-environment temperature (40A)

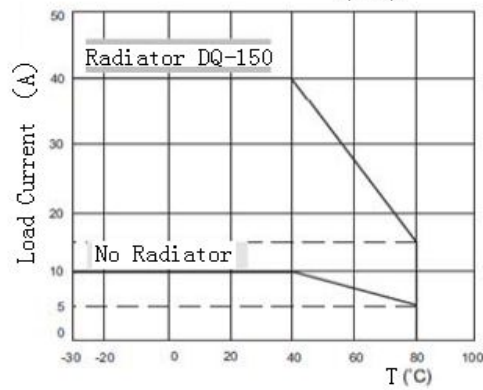

Load current-environment temperature (60A)

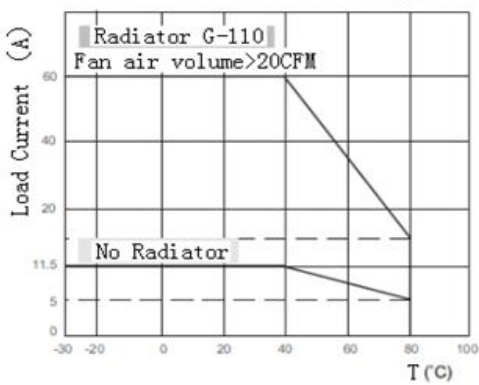

Load current-environment temperature (70A)

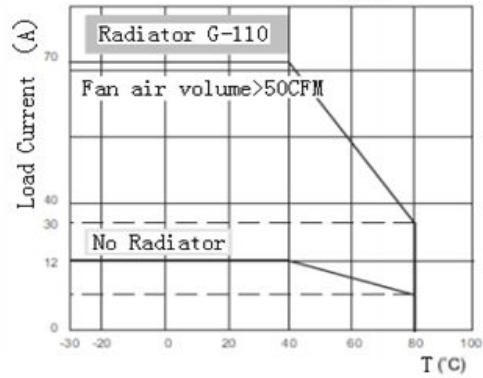

Load current-environment temperature (80A)

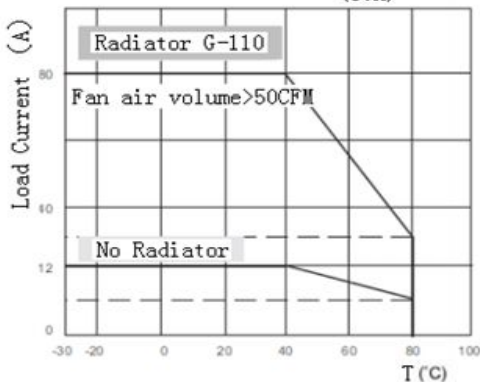

Load current-environment temperature (100A)

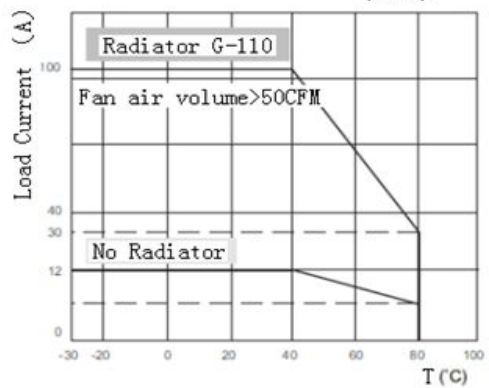

## ■ Dimension

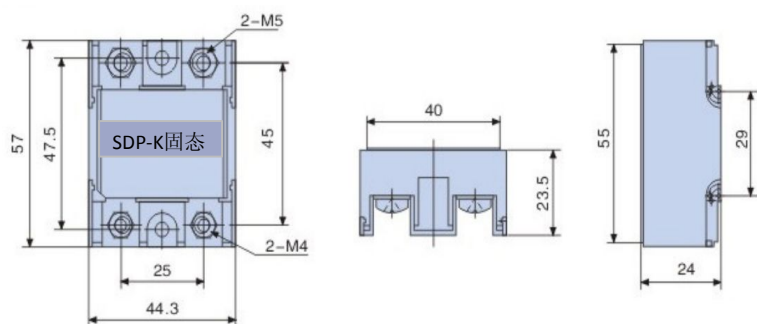

## ■ Matters needing attention

Depends on the condition of products using, when the temperature of SSR is high, it needs to reduce load current and heat dissipating capacity