



## SDP Flip Type Series Solid State Relays

Max rated value:80Amps@1000VDC、  
@400VDC、 20Amps@110VDC

●DC Solid state relay is low impedance which is MOSFET/IGBT output and maximum to avoid total power consumption

●Input Control Voltage:3-32VDC

●Normally SSR is good for resistive and inductive load. (like motor and EMR/ electromagnetic coil which is inductive load that must avoid diode)



### ■Species

Insulation way	Distance between the input terminal	LED Instructions	Load Current	Load Voltage	Model
Photoelectric three-terminal two-way thyristor switch	25mm	LED	5A-20A	12-110VDC	SDP11 Series
	25mm	LED	5A-80A	12-400VDC	SDP40 Series
	25mm	LED	5A-80A	12-1000VDC	SDP80 Series

### ■Performance and related technical parameters

Product model	SDP4010D-K SDP4020D-K SDP4025D-K SDP4040D-K SDP4050D-K SDP4060D-K SDP4080D-K									
Main technical parameters										
Load voltage	40-110VDC 40-400VDC 40-1000VDC									
Max Load current	5A	10A	15A	20A	25A	30A	40A	50A	60A	80A
Isolation bet. In & out	≧ 2000VAC									
Isolation to case	≧ 2500VAC									
Control voltage	3.5-32VDC									
Control current	6-25mA									
Turn-on voltage	≧ 1.3VAC									
Frequency range	47/63Hz									
Status indicator	LED									
Operating temperature	-40~80℃									

■ Reference data

Load current-environment temperature (10A)

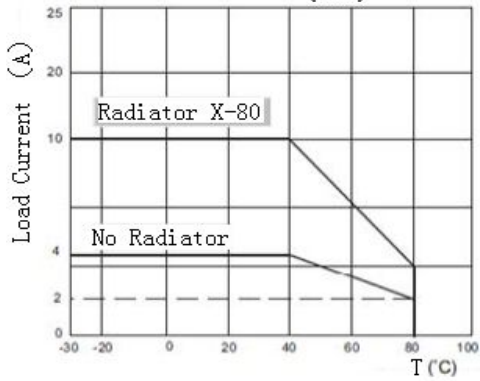

Load current-environment temperature (15A)

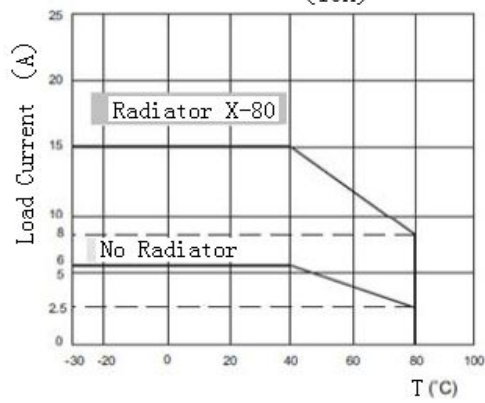

Load current-environment temperature (20A)

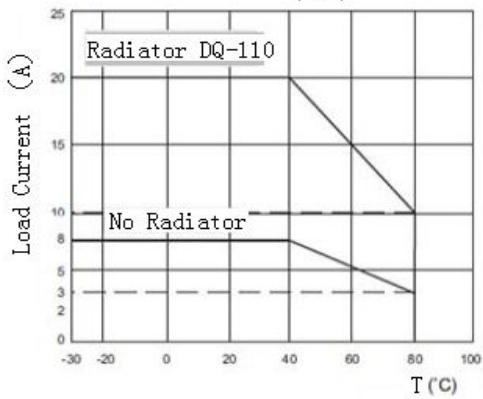

Load current-environment temperature (40A)

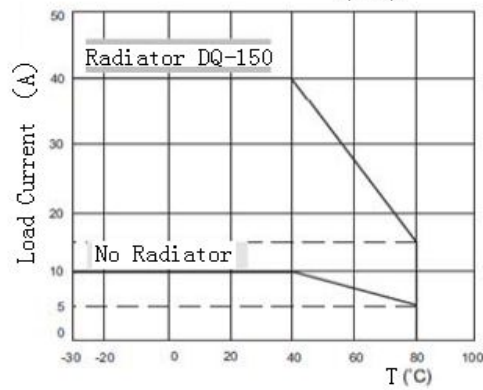

Load current-environment temperature (60A)

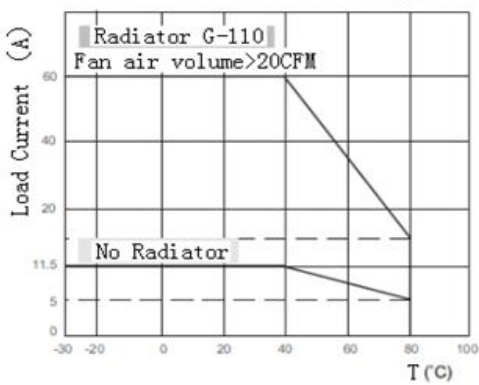

Load current-environment temperature (70A)

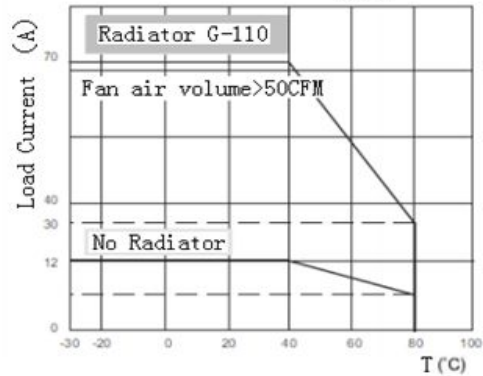

Load current-environment temperature (80A)

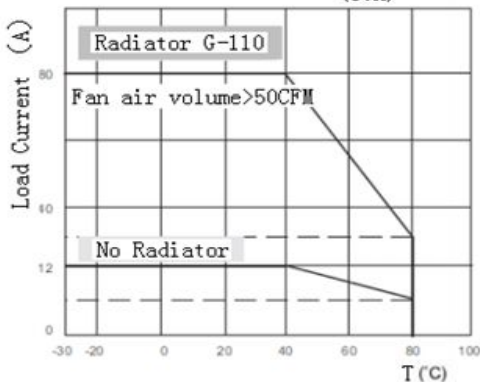

Load current-environment temperature (100A)

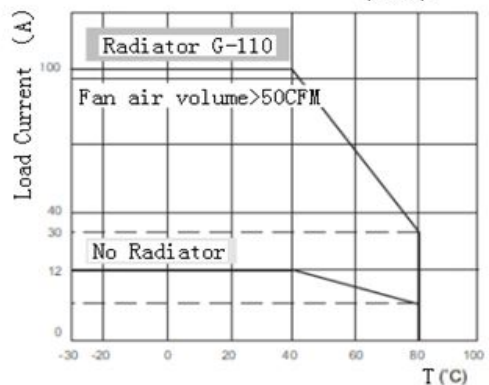

## ■ Dimension

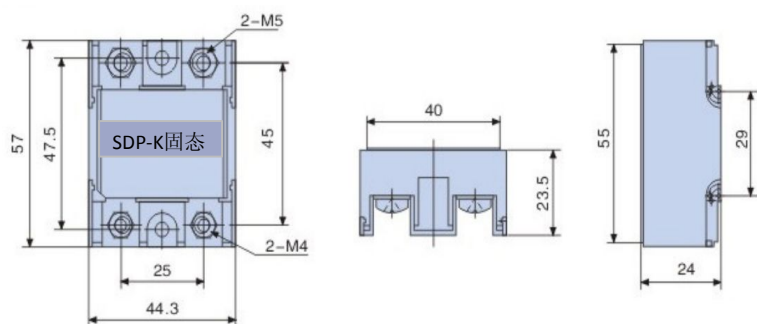

## ■ Matters needing attention

Depends on the condition of products using, when the temperature of SSR is high, it needs to reduce load current and heat dissipating capacity